

Finding HCMC Orange Building, Room 09.115 A & B

**Corner of South 8th Street and Chicago Ave., Minneapolis, MN 55404 (Orange Building)
Corner of South 9th Street and Chicago Ave. for Parking—can enter ramp from 8th or 9th**

Finding the classroom from Outside the Building:

Enter the main entrance of HCMC Blue building from South 8th Street (directly across the street from the Parkside Professional Building). Once inside the door, take a right and head towards the information desk. Turn left and go past the gift shop and coffee stand to the open stairway on your right. Take the stairs to the lower level. Turn to your right at the bottom of the stairs. *Take a left at the first hallway intersection and continue straight ahead until you see a blue line on the floor. Turn left and follow the blue line until it nearly ends. Turn right and continue past Room OL200 to the OL elevators (2 sets of elevators that face each other). Take the OL elevators to 9th floor. When you exit the elevators turn down the short hallway by the drinking fountain. The room is about 20 steps from the elevator and there is a phone on the wall outside the room.

Finding the classroom from the Hospital Parking 2 Ramp:

Take the ramp elevators to the lower level. Follow the signs to the hospital. Follow the hallway past the stairway and vending machines. Follow directions above from *.

Driving Directions to HCMC:

From the Northeast:

Take 35W south to Exit 17C (Washington Avenue). Turn right onto Washington. Follow Washington Avenue to Chicago Avenue and turn left. Take a left onto 9th street. Turn left again to enter the Hospital Parking 2 Ramp. Take the ramp elevator to the lower level and follow the instructions above.*

From the Northwest: Take I-94 east to exit 230 (4th Street). Follow 4th Street through downtown to Chicago Avenue and turn right onto Chicago Avenue. Follow Chicago to 9th Street and turn left. Turn left again to enter the Hospital Parking 2 Ramp. Take the ramp elevators to the lower level and follow the instructions above.*

From the East: Take I-94 W to exit 234B (7th Street). Follow 7th Street and turn left on Chicago Avenue. Follow Chicago to 9th Street and turn left. Turn left again to enter the Hospital Parking 2 Ramp. Take the ramp elevators to the lower level and follow the instructions on the previous page.*

From the South: All downtown exits are closed from northbound 35W. Consult www.mndot.gov/35w94 for information about closures and alternate routes. Park in the Hospital Parking 2 Ramp; entrances off of 8th or 9th Street. Take the ramp elevators to the lower level and follow the directions on the previous page.*

From the West: 394 East to Exit 9B (6th Street). Follow 6th Street to the HCMC Parking ramp (just past Portland Ave. on the right side).

Public transportation is another options for getting downtown. For bus schedules and information, go to www.metrotransit.org. **Light Rail Transit to HCMC:** HCMC is located at the corner of Park Ave. and 6th Street, conveniently located just 1-1/2 blocks south of the Downtown East/Metrodome station of the Light Rail Transit line. Light Rail information is available at www.metrotransit.org/rail/index.asp.

Parking:

There are various options for parking around HCMC, but we suggest you park in the Hospital Parking 2 Ramp (see HCMC Campus Map). Directions and maps guide you to and from this ramp. Meters are available around the hospital and vary in price. Check www.mplsarking.com for rates.

Parking rates are subject to change without notice. The program coordinator will have a limited number of discount coupons for the Hospital Parking 2 Ramp available for \$7.00. You must pay with cash or check in the exact amount for the discount coupon—change is not available.



HennepinHealthcare

HCMC CAMPUS

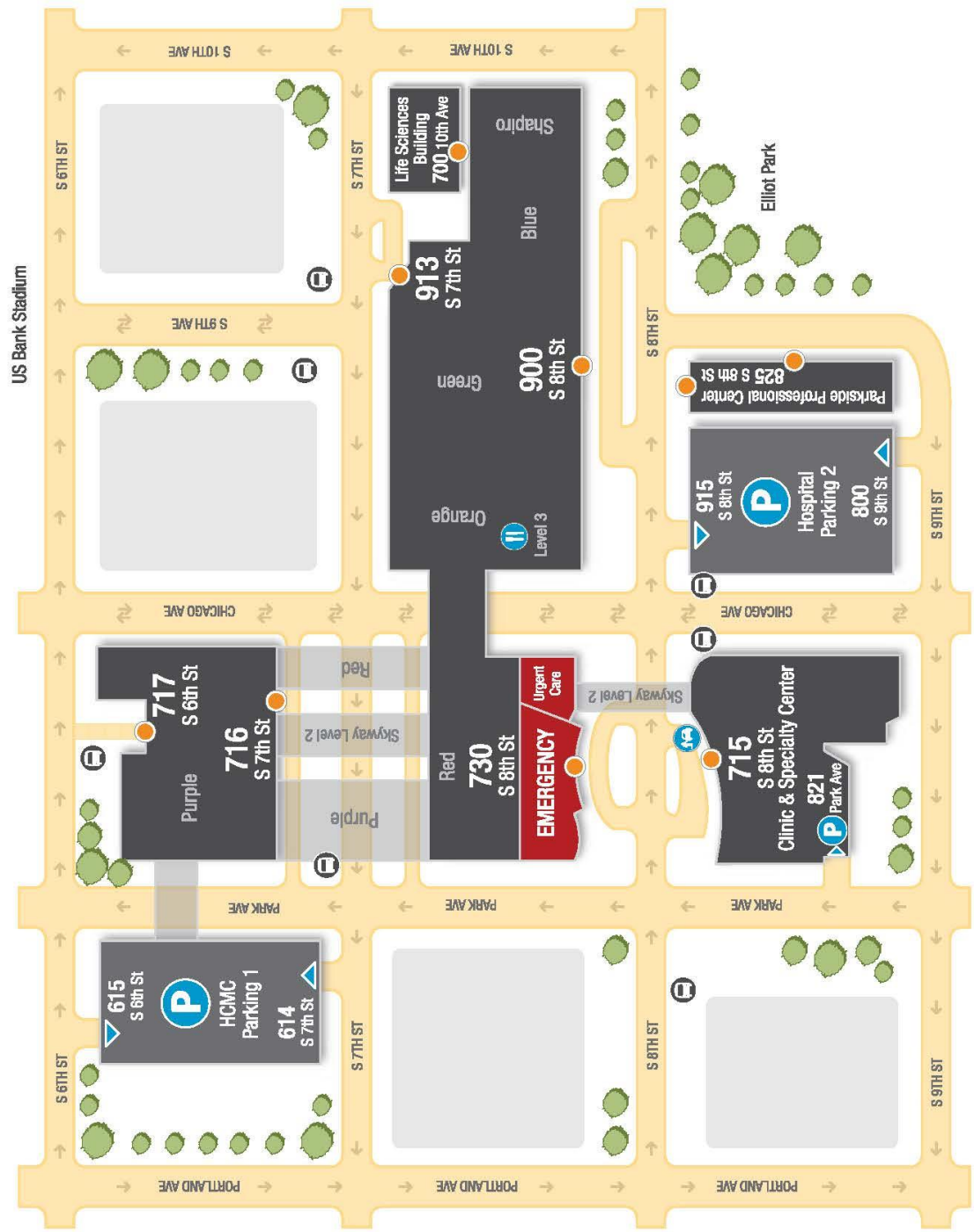

LEGEND



Entrance



Parking Entrance



Visitor Parking



Valet Parking



Cafeteria



Metro Transit

LOWER LEVEL

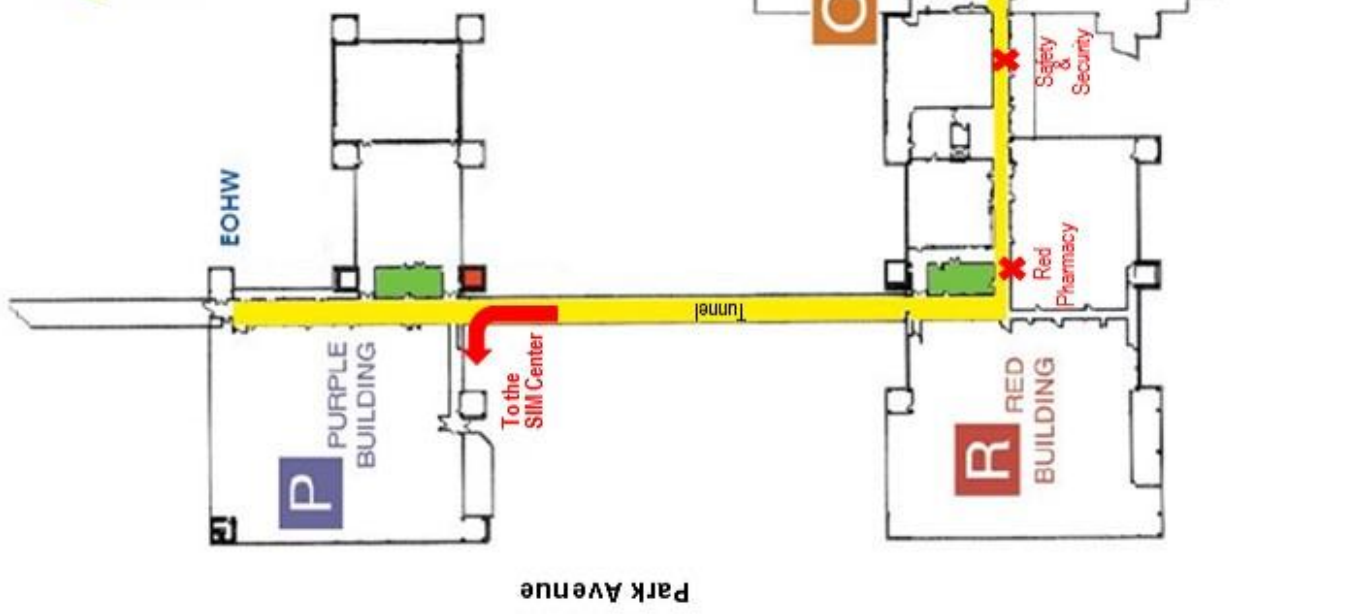

Take the Orange elevators to 9th floor for classes in O9.115

Take Hospital 2 Ramp elevators in the Parkside Bldg. to Lower Level and follow tunnel to get to the Blue building.

S. 8th Street